

## Lifting stati. Aqualift F XL 200l Duo, SPF 1500-S3, Cast-iron gate valve

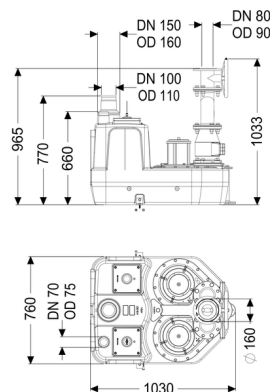

### Article information

Item no.: 11025  
 GTIN: 4026092056929  
 Price group: 50

### Advantages

- Different performance classes available
- Pressure sensor for reliable pneumatic level measurement
- Maximum operating reliability due to intelligent control unit (Duo)

### Description

The lifting station for faecal and faecal-free wastewater is equipped with a submersible pump and a backflow preventer. The collection tank made of permanently resistant polymer (PE) offers universal connection options and has a screwed access cover.

The station is controlled by a user-friendly control unit, which can be optionally integrated in the building management system via a potential-free contact or alarm and collective fault messages can be output via a GSM interface (Comfort control unit).

Type of wastewater: wastewater with sewage  
 Installation situation: free-standing set-up

### Version:

Type of system:	Twin pump station
Installation:	Dry installation
Shut-off valve:	Shut-off valve made of cast iron
Pump control:	Control unit
Backflow preventer:	integrated
Sound absorption mat:	yes

Delivery state:

Installation-ready (electrical components,  
connection parts must be connected on site)

### General characteristics:

Colour: black  
Standard: EN 12050-1

### Dimensions:

Length: 980 mm  
Width: 760 mm  
Height: 807 mm

### Tank:

Number of inlets: 1 ST  
Inlet nominal size (DN): 100  
Inlet nominal size (OD): 110 mm  
Inlet max. scoring (DN): 200 mm  
Distance from centre of outlet pipe to tank  
bottom: 610 mm  
Connection for manual diaphragm pump (DN): 32  
Tank volume: 200 l  
Pumping volume: 120 l  
Pressure pipe connection: vertical  
Pressure pipe connection (DN): 100 mm  
Pressure pipe connection (OD): 110 mm  
Venting connection (DN): 70 mm  
  
Free passage: 40 mm

### Pumping device:

Pump: SPF 1500  
Number of pumps: 2  
Max. pumping capacity: 40 m<sup>3</sup>/h  
Max. pumping height: 8 m  
Operating mode: S3 - 50 %  
Power P1: 1.4 kW  
Power P2: 1.1 kW  
Speed: 1,415 U/min  
Max. temperature (permanent) of conveyed  
material: 40 °C  
Connection type: Direct connection  
Weight: 24 kg  
Impeller type: Multi-vane impeller

Length of mains cable for pump:	5 m
Rated current:	2.7 A
Protection class (pump):	IP 68 (3m/48h)
Protection class:	I
Type of pump connection cable:	H07RN-F 7G 1.5 mm <sup>2</sup>
Temperature monitoring:	integrated
Cos phi - power factor:	0.77
Insulation class:	F

### Control:

Control unit:	Comfort
Operating voltage:	400 V
Mains frequency:	50 Hz
Self-diagnosis system (SDS):	yes
Battery buffering:	yes
Multi-line display:	yes
Log book function:	yes
USB interface:	yes
GSM interface:	yes
Potential-free contact:	yes
Type of fuse required (electrical protection):	3 x C 16 A
Motor protection switch:	yes
Protection class control unit:	IP 54
Length of mains cable for control unit:	0 m
Type of level measurement:	pneumatic
Level measurement instrument:	Immersion pipe
Alarm sensor:	Immersion pipe