

Yard drain System 400, DN 150, B, 580-710 mm

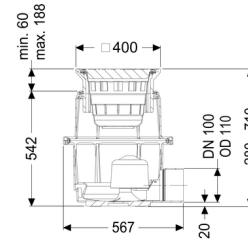

Article information

Item no.: 851151B
 GTIN: 4026092004388
 Price group: 10

Advantages

- Different load classes available
- Height-adjustable complete system
- Easy underground installation

Description

The polymer yard drain is used for point drainage and is resistant to aggressive wastewater. It is equipped with a sludge bucket and fuel resistant seals.

The polymer upper section enables continuous height and level adjustment.

Version:

| | |
|-------------|----------|
| System: | 400 |
| Odour trap: | included |
| Heating: | without |

| | |
|---|-------------------|
| Waterproofing layer on the upper section: | Connection flange |
|---|-------------------|

General characteristics:

| | |
|----------------------|--------|
| Nominal size (DN): | 150 |
| Outer diameter (OD): | 160 |
| Colour: | black |
| Standard: | EN 752 |

Dimensions:

| | |
|---------------------------|--------|
| Length: | 563 mm |
| Width: | 500 mm |
| Height: | 580 mm |
| Cutout dimension, length: | 585 mm |
| Cutout dimension, width: | 535 mm |
| Min. insertion depth: | 55 mm |

Tank:

| | |
|--|--------------|
| Installation depth: | 580 - 710 mm |
| Groundwater resistant from lower edge of base section: | 500 mm |

Drain body:

| | |
|-------------------------|-------------------------------------|
| Material of drain body: | Polymer |
| Socket version: | lateral |
| Vertical adjustment: | vertically adjustable upper section |
| Vertical adjustment: | 55 - 180 mm |
| Adjustment range: | 55 - 185 mm |

Coverage features:

| | |
|-----------------|---------------------|
| Type of cover: | Round slotted cover |
| Cover material: | Grey iron |
| Load class: | B 125 (EN 124) |
| Length: | 400 mm |
| Width: | 400 mm |
| Sludge bucket: | yes |

Grating:

| | |
|--|---------|
| Rim length: | 400 mm |
| Rim width: | 400 mm |
| Shape of upper section: | square |
| Discharge rate (l/s) with 20 mm backwater: | 4.5 l/s |