

Engineering systems base *Aquapump XL Mono / Duo* Wet installation, for wastewater without or without sewage



EN 12050-1 EN 12050-2

Tank volume: 680 liters

Pump volume: max. 350 liters

Polyethylene system base for underground installation, resistant to aggressive media. With Ø 160 mm inlet. For connection to Ø 1000 mm system chamber. Handles groundwater depths up to 3.000 mm.

With **single or twin removable wastewater pump(s)**

- with multi-vane impeller (GTF)

- single-channel impeller (GTK)

for wastewater with or without sewage (without ATEX requirements). With float switch / hydrostatic sensor for level measurement. Pressure pipe Ø 63/90 mm outside diameter (welded PE pipe is to be used for the pressure pipe), including backflow preventer and closure valve on pressure pipe side.

Power cable length: 10 m (30 m on request).

Control unit

With control unit (versions with hydrostatic sensor) with self-diagnosis system (SDS), battery buffering and logbook function, control unit is splashproof (IP 54).

➤ **Installation:** in combination with system chambers page 156 – 157

➤ **Accessories:** pages 167 – 170

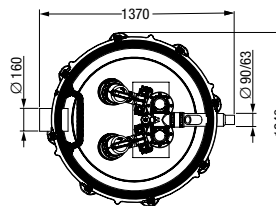
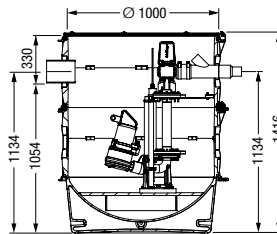

Mono version with one pump

GTF pump	Pumping volume in liters	Voltage	Art. no.
1400-S1**	340	230 V	874 30 32
1400-S1	340	230 V	874 30 33
1400-S1	340	400 V	874 30 47
1600-S1	350	400 V	874 30 20
2600-S1	350	400 V	874 30 21
4000-S1	350	400 V	874 30 22

GTK pump	Pumping volume in liters	Voltage	Art. no.
1300-S1	350	400 V	874 30 26
2600-S1	350	400 V	874 30 27
3700-S1	350	400 V	874 30 28

Duo version with two pumps

GTF pump	Pumping volume in liters	Voltage	Art. no.
1400-S1	340	230 V	874 30 34
1400-S1	340	400 V	874 30 48
1600-S1	340	400 V	874 30 23
2600-S1	340	400 V	874 30 24
4000-S1	340	400 V	874 30 25

GTK pump	Pumping volume in liters	Voltage	Art. no.
1300-S1	340	400 V	874 30 29
2600-S1	340	400 V	874 30 30
3700-S1	340	400 V	874 30 31

** Version with float switch

Pumping capacity

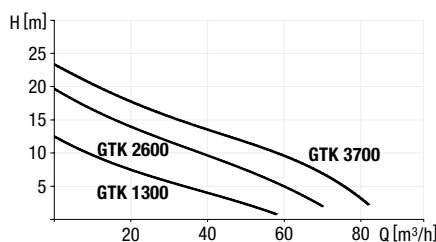
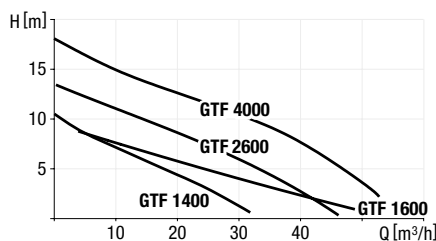

Pump type

Pump type	Voltage	Amperage	Input Power (P1)	Power (P2)	Pumping capacity	Pumping height
GTF 1400-S1*	230 V	6.5 A	1.5 kW	1.1 kW	31 m³/h	10.5 m
GTF 1600-S1*	400 V	2.9 A	1.6 kW	1.2 kW	49 m³/h	9.3 m
GTF 2600-S1*	400 V	4.5 A	2.6 kW	2.1 kW	46 m³/h	13.6 m
GTF 4000-S1*	400 V	6.6 A	4.0 kW	3.4 kW	53 m³/h	18 m

* Definition of S1-pumps see page 97

Pump type

Pump type	Voltage	Amperage	Input Power (P1)	Power (P2)	Pumping capacity	Pumping height
GTK 1300-S1*	400 V	2.5 A	1.3 kW	1.0 kW	57 m³/h	12.4 m
GTK 2600-S1*	400 V	4.9 A	2.6 kW	2.1 kW	71 m³/h	19.6 m
GTK 3700-S1*	400 V	6.5 A	3.7 kW	3.1 kW	82 m³/h	23.5 m

* Definition of S1-pumps see page 101

