

## Grease separator *EasyClean Modular* Standard and Direct NS 1 – 4



for free-standing installation, two component version

EN 1825

Made of polyethylene PE-HD

**Installation:** In frost-protected rooms

**Version:** Can be disassembled

**Delivery:** System completely assembled (only NS 1)

**Note for NS 1:** The separated grease must be skimmed off daily in the case of weekly emptying and cleaning.

**Custom made product:** Delivery time on request

➤ **Accessories for NS 2 / NS 3 / NS 4:** Sampling chamber, refill inlet, inspection window, *SonicControl* from page 361 – 363, lifting stations see chapter "3"



Illustration shows Art. no. 93 001



Illustration shows Art. no. 93 002-R

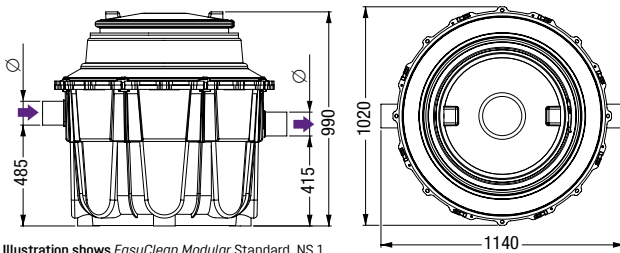

Illustration shows *EasyClean Modular* Standard, NS 1

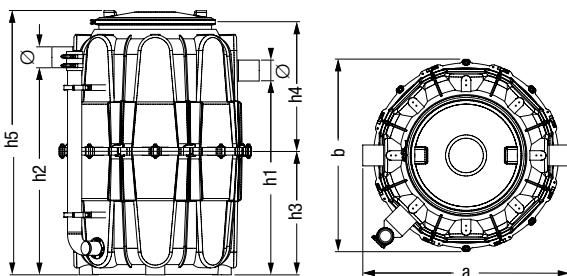

Illustration shows *EasyClean Modular* Direct, NS 3

### *EasyClean Modular* Standard

NS	Art. no.
NS 1	93 001
NS 2	93 002-R
NS 3	93 003-R
NS 4	93 004-R

### *EasyClean Modular* Direct with direct disposal

NS	Art. no.
NS 2	93 002.00/D1-R
NS 3	93 003.00/D1-R
NS 4	93 004.00/D1-R

NS	Ø (mm)	a (mm)	b (mm)	h1 (mm)	h2 (mm)	h3 (mm)	h4 (mm)	h5 (mm)	Weight (kg)	Sludge trap (l)	Water and grease (l)	Grease storage (l)	Total (l)
1	110								65	100	100	40	200
2	110	1100	1020	1020	1090	650	690	1395	60	200	400	100	600
3	110	1100	1020	1020	1090	650	690	1395	60	300	300	120	600
4	110	1400	1300	1090	1160	765	790	1620	110	400	560	160	960

Ø = Outer diameter h4 × b = access opening